

Temperature Sensors and Pockets

For fitting in pockets or directly in liquid flow

Heat resistant silicone cable

Delivered as a set

Sensor tube material, stainless steel

Fast response time

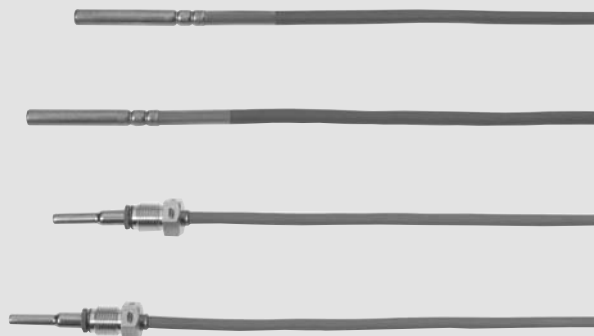

TS 27.01
111
EN 1434

TS 27.01
112
EN 1434

Application

A sensor set is used together with an electronic heat meter for measuring flow and return flow temperatures in heating installations.

Depending on the type, the sensors can be used directly in the liquid flow (direct sensor) or fitted in a sensor pocket.

The sensor has a built-in platinum resistor with an electric resistance, which changes with the temperature. Measuring the resistance value gives an analog indication of the temperature.

A heat meter calculates the differential temperature of a heating installation on the basis of measured flow and return flow temperatures. Based on the differential temperature and the volume of liquid measured, the energy consumed can then be calculated and summed up.



Kamstrup A/S
Industrivej 28, Stilling
DK-8660 Skanderborg
TEL: +45 89 93 10 00
FAX: +45 89 93 10 01
E-MAIL: energi@kamstrup.dk
WEB: www.kamstrup.com

Technical data

	Pocket mounted sensor	Short direct sensor
Element	Pt500 according to EN 60751	
Δt deviation	0.04°C	
Pairing	40°C and 130°C, control/sample at 85°C (depending on approval)	
Temperature of medium	0...150°C short-term 160°C	
Ambient temperature	-10...70°C	
Storage & transp. temp.	-25...70°C	
Response time $\tau_{0.5}$	5 sec.	2 sec.
Medium	Heating water	
Humidity	<98% RF condensing	
Pressure level	Pocket	PN16
Diameter	ø5.85 mm	ø4/5.6 mm
Sensor tube length	45 mm	>27.5 mm
Silicone cable	2 x 0.5 mm ² , 1.5 m, 3 m, 5 m, 10 m and 20 m	2 x 0.25 mm ² , 1.5 m and 3 m
Sensor tube material	AISI 304, W-no. 1.4301	AISI 316 Ti, W-no. 1.4571
Density	IP65	IP67

Approvals

HEAT SENSOR

TS27.01/111, DS/EN 1434 θ: 20...150°C, Δθ: 3...130 K

TS27.01/112, DS/EN 1434 θ: 20...130°C, Δθ: 3...130 K

Technical data

POCKETS

Temperature of medium	0 - 160°C
Medium	Heating water
Response time $\tau_{0.5}$	Max. 8 s for 65 and 90 mm pocket Max. 25 s for 140 mm pocket
Pressure level	PN25
Flow velocity	Max. 3 m/sec.
Diameter	8 mm (14.5 mm)
Length	65, 90 and 140 mm
Connection	R ¹ / ₂
Nipple and sensor tube material	AISI 304, W-no. 1.4301 for 65 and 90 mm AISI 316, W-no. 1.4571 for 140 mm

CHANGE-OVER NIPPLES, SHORT DIRECT SENSOR

Connection	R ¹ / ₂ or R ³ / ₄
Material	MS 58 pb

Fitting examples

EXAMPLE 1

Direct mounted short sensor, type no. 66-00-0F0/0G0, fitted in an elbow by means of change-over nipple, type no. 65-56-491.

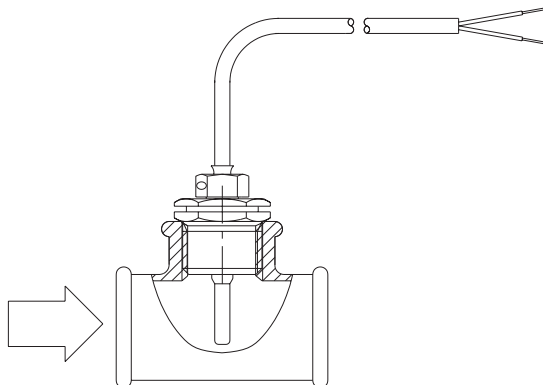

EXAMPLE 2

Direct mounted short sensor, type no. 66-00-0F0/0G0, fitted in ULTRAFLW®, type no. 65-S-CDA-XXX.

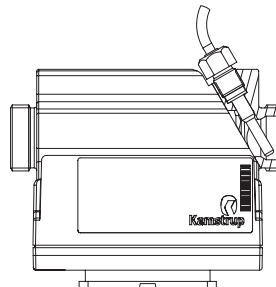

EXAMPLE 3

Pocket mounted sensor, type no. 66-00-0A0/0B0/0C0/0D0/0E0, fitted in an elbow by means of sensor pocket, type no. 65-57-3XX.

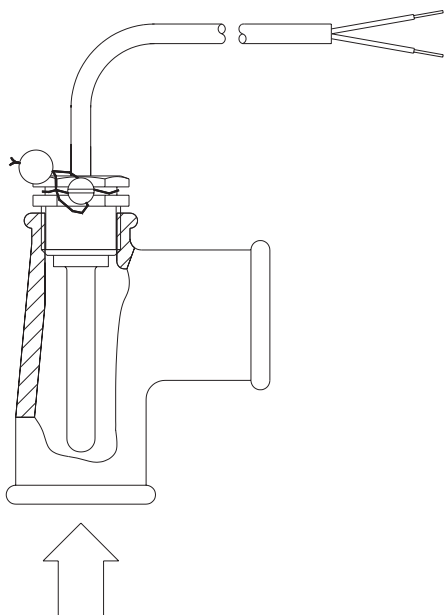

EXAMPLE 4

Pocket mounted sensor, type no. 66-00-0A0/0B0/0C0/0D0/0E0, fitted in an elbow with 45° angle by means of sensor pocket, type no. 65-57-3XX.

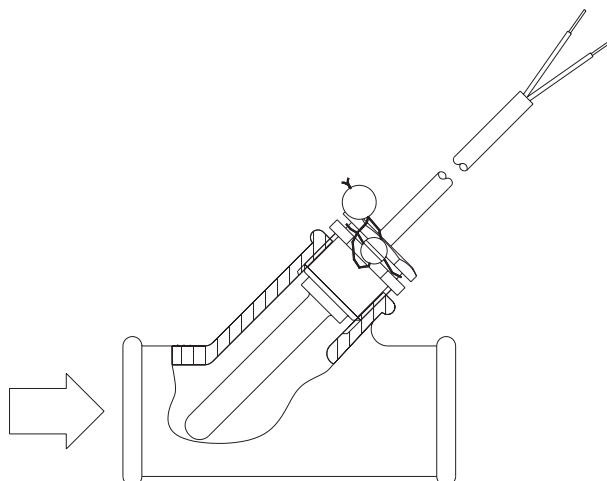

Sealing examples

Direct mounted short sensor seal with change-over nipple M10 x R1½.

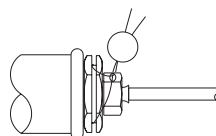

Pocket mounted sensor seal in sensor pocket.

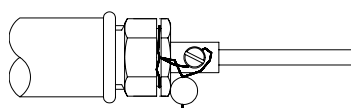
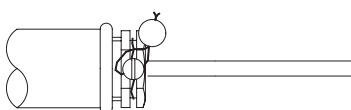

Dimensional drawings

DIRECT MOUNTED SHORT SENSOR

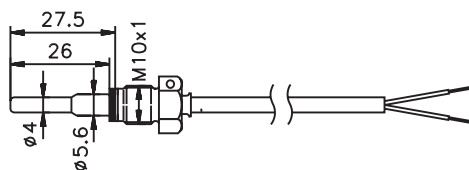

POCKET MOUNTED SENSOR



CHANGE-OVER NIPPLES

DIRECT MOUNTED SHORT SENSOR

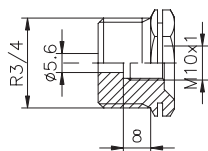
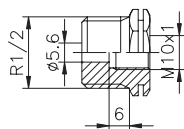

SENSOR POCKET

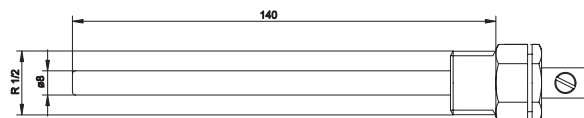

140 mm

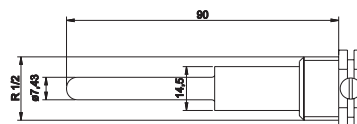

90 mm

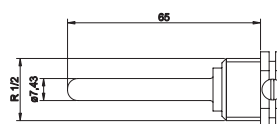

65 mm

Order specification

TEMPERATURE SENSOR SET

TYPE NO.*	DESCRIPTION
66-00-0A0 XXX	Pt500 pocket mounted temperature sensor set with 1.5 m cable
66-00-0B0 XXX	Pt500 pocket mounted temperature sensor set with 3.0 m cable
66-00-0C0 XXX	Pt500 pocket mounted temperature sensor set with 5 m cable
66-00-0D0 XXX	Pt500 pocket mounted temperature sensor set with 10 m cable
66-00-0E0 XXX	Pt500 direct mounted short temperature sensor set with 20 m cable
66-00-0F0 XXX	Pt500 direct mounted short temperature sensor set with 1.5 m cable
66-00-0G0 XXX	Pt500 direct mounted short temperature sensor set with 3.0 m cable

* Type numbers may vary due to local approvals

ACCESSORIES

TYPE NO.	DESCRIPTION
65-56-491	Change-over nipple M10 - R $\frac{1}{2}$ for direct mounted short temperature sensor
65-56-492	Change-over nipple M10 - R $\frac{3}{4}$ for direct mounted short temperature sensor
65-57-324	Sensor pocket, length = 65 mm
65-57-327	Sensor pocket, length = 90 mm
65-57-314	Sensor pocket, length = 140 mm