



## MCS Series Power Supply

### MULTIPLE 24 VAC POWER SUPPLY, INDOOR

#### Product Features

- 2, 5, 10, or 20 Amp Capacities
- 4, 8, or 16 Outputs
- Fuse or Circuit Breaker Protection;  
Spare Fuses Included with Fused Models Only
- 120 VAC or 230 VAC Selectable Input
- 24 VAC Output or 28 VAC Output for Longer Wire Runs
- AC Power Indicator with Power On/Off Switch
- Compatible with Cameras, Domes, and Pan/Tilts
- Models with Circuit Breakers Have Class 2 Rated Outputs



MCS16-10

Power supplies in the **MCS Series** offer a variety of configurations for powering up to 16 units from a single power source.

The power supplies provide 24 VAC output for 4, 8, or 16 units. To compensate for voltage losses over long wire runs, 28 VAC outputs also are available on most models. The power supplies have a selectable input of 120 or 230 VAC and are packaged in an easy-to-install metal enclosure that has ample room for wiring connections and conduit entries.

For integrated systems such as Spectra® and Esprit® the higher capacity models are capable of handling pan/tilt and receiver operation in addition to camera functions. (See product capacity chart.)

Models are available with either fuses or self-resetting circuit breakers on each output. Fused models provide a greater degree of protection for the camera because they are faster acting and more precise. Circuit breakers will self-reset when the fault is corrected, eliminating the need for replacing fuses. However, the amount of current required to trip a circuit breaker can vary as much as 100% depending on temperature. In the fused models, the values of fuses can be changed depending upon the specific current requirements of the equipment connected.

The **MCS16-10S**, **MCS16-10SB**, **MCS16-20S**, and **MCS16-20SB** are 16-output supplies that have individual power switches and LEDs on each output. This is a popular feature in larger systems where it is frequently necessary to power-down individual units.

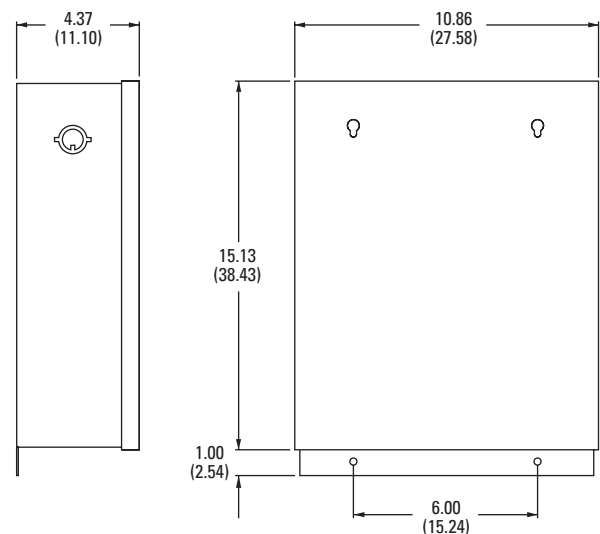

NOTE: VALUES IN PARENTHESES ARE CENTIMETERS;  
ALL OTHERS ARE INCHES.



C653 / REVISED 10-06



International Standards  
Organization Registered Firm;  
ISO 9001 Quality System



# TECHNICAL SPECIFICATIONS

## MODELS

|            |  |
|------------|--|
| MCS4-2     | Indoor multiple power supply, 120/230 VAC input. Four fused 24 VAC outputs, total current capacity of 2 A (48 VA).               |
| MCS4-2B    | Same as MCS4-2 except has circuit breakers.  |
| MCS8-5     | Indoor multiple power supply, 120/230 VAC input. Eight fused 24/28 VAC outputs, total current capacity of 5 A (120 VA).          |
| MCS8-5B    | Same as MCS8-5B except has circuit breakers.   |
| MCS16-10   | Indoor multiple power supply, 120/230 VAC input. Sixteen fused 24/28 VAC outputs, total current capacity of 10 A (240 VA).       |
| MCS16-10B  | Same as MCS16-10 except has circuit breakers.  |
| MCS16-10S  | Same as MCS16-10 except each output has a power switch and power indication LED.   |
| MCS16-10SB | Same as MCS16-10S except has circuit breakers.   |
| MCS16-20   | Indoor multiple camera power supply, 120/230 VAC input. Sixteen fused 24/28 VAC outputs, total current capacity of 20A (480 VA). |
| MCS16-20B  | Same as MCS16-20 except has circuit breakers.  |
| MCS16-20S  | Same as MCS16-20 except each output has a power switch and power indication LED.   |
| MCS16-20SB | Same as MCS16-20S except has circuit breakers.   |

### Product Capacity Chart

A partial list of compatible products and the number of units that may be powered by each power supply are listed below. Capacity is based on the vA rating of each product to be used with the power supply.

| Product                        | Power Supply Model         |                             |                                 |                                 |
|--------------------------------|----------------------------|-----------------------------|---------------------------------|---------------------------------|
|                                | MCS4-2/<br>4-2B<br>(48 VA) | MCS8-5/<br>8-5B<br>(120 VA) | MCS16-10/<br>16-10B<br>(240 VA) | MCS16-20/<br>16-20B<br>(480 VA) |
| CCD Camera (12 VA)             | 4                          | 8                           | 16                              | 16                              |
| Indoor DF5 with camera (3 VA)  | 4                          | 8                           | 16                              | 16                              |
| Indoor DF8 with camera (12 VA) | 4                          | 8                           | 16                              | 16                              |
| Indoor Spectra® (25 VA)        | 1                          | 4                           | 8                               | 16                              |
| Esprit® (70 VA)                | —                          | 1                           | 3                               | 6                               |

## MECHANICAL

|             |  |
|-------------|--|
| Cable Entry | Four knockouts for either 1/2-inch (1.27 cm) or 3/4-inch (1.91 cm) conduit |
|-------------|--|

## ELECTRICAL

|                  |   |
|------------------|---|
| Input Voltage    | 120 or 230 VAC, 50/60 Hz (as noted in model number) |
| Output Voltage   |   |
| MCS4-2           | 24 VAC  |
| All Other Models | 24/28 VAC   |

|   |   |
|---|---|
| Output Fuse/<br>Circuit Breaker Ratings |   |
| MCS4-2, MCS4-2B                         | 1.5 A*  |
| All other models                        | 3 A*  |
| Input Connectors                        | Wire nut  |
| Output Connectors                       | Screw-type barrier strips; models with circuit breakers are suitable for Class 2 wiring |
| Input Wire Size                         | 12-16 gauge solid wire  |
| Output Wire Size                        | 12-22 gauge solid or stranded wire  |
| Recommended                             |   |
| Wiring Distances                        | See chart below   |

The following are the recommended maximum distances (transformer to load) and are calculated with a 10-percent voltage drop. (Ten percent is generally the maximum allowable voltage drop for AC-powered devices.) Distances are calculated in feet; values in parentheses are meters.

### Recommended Wiring Distance Chart

| Input Voltage | Total VA Consumed | Wire Gauge                       |                                  |                                  |
|---------------|-------------------|----------------------------------|----------------------------------|----------------------------------|
|               |                   | 20 AWG<br>(0.5 mm <sup>2</sup> ) | 18 AWG<br>(1.0 mm <sup>2</sup> ) | 16 AWG<br>(1.5 mm <sup>2</sup> ) |
| 24 VAC        | 10                | 283 (86)                         | 451 (137)                        | 716 (218)                        |
|               | 20                | 141 (42)                         | 225 (68)                         | 358 (109)                        |
|               | 30                | 94 (28)                          | 150 (45)                         | 238 (72)                         |
|               | 50                | 56 (17)                          | 90 (27)                          | 143 (43)                         |
| 28 VAC        | 10                | 386 (117)                        | 614 (187)                        | 975 (297)                        |
|               | 20                | 193 (58)                         | 307 (93)                         | 487 (148)                        |
|               | 30                | 128 (39)                         | 204 (62)                         | 325 (99)                         |
|               | 50                | 77 (23)                          | 122 (37)                         | 195 (59)                         |

## GENERAL

|                       |                                      |
|-----------------------|--------------------------------------|
| Construction          | Steel                                |
| Finish                | Charcoal black polyester powder coat |
| Environment           | Indoor                               |
| Operating Temperature | 32° to 120°F (0° to 50°C)            |
| Weights               | Unit Shipping                        |
| MCS4-2                | 14.10 lb (6.40 kg) 17 lb (7.70 kg)   |
| MCS4-2B               | 13.89 lb (6.30 kg) 17 lb (7.70 kg)   |
| MCS8-5                | 17.05 lb (7.73 kg) 20 lb (9.07 kg)   |
| MCS8-5B               | 16.85 lb (7.64 kg) 20 lb (9.07 kg)   |
| MCS16-10              | 20.72 lb (9.40 kg) 24 lb (10.87 kg)  |
| MCS16-10B             | 20.72 lb (9.40 kg) 24 lb (10.87 kg)  |
| MCS16-10S             | 20.35 lb (9.23 kg) 23 lb (10.41 kg)  |
| MCS16-10SB            | 20.48 lb (9.29 kg) 23 lb (10.41 kg)  |
| MCS16-20              | 22.50 lb (10.21 kg) 26 lb (11.77 kg) |
| MCS16-20B             | 22.47 lb (10.19 kg) 26 lb (11.77 kg) |
| MCS16-20S             | 22.27 lb (10.10 kg) 25 lb (11.32 kg) |
| MCS16-20SB            | 22.28 lb (10.11 kg) 25 lb (11.32 kg) |

## CERTIFICATIONS/RATINGS

- CE
- UL Listed
- UL Listed to Canadian safety standards
- China Compulsory Certification
- Meets NEMA Type 1 standards

\*Individual output cannot exceed this rating, and the total of all outputs cannot exceed the overall rating of the power supply (see the Models section).



### Pelco Worldwide Headquarters:

3500 Pelco Way, Clovis, California 93612-5699 USA  
**USA & Canada** Tel: (800) 289-9100 • FAX (800) 289-9150  
**International** Tel: (559) 292-1981 • FAX (559) 348-1120  
[www.pelco.com](http://www.pelco.com)

Pelco, the Pelco logo, Spectra, and Esprit are registered trademarks of Pelco.  
 Specifications subject to change without notice.  
 ©Copyright 2006, Pelco. All rights reserved.